

To be read in conjunction with Mark Hanton Studio drawings MHS175.17-001, 002, & 003

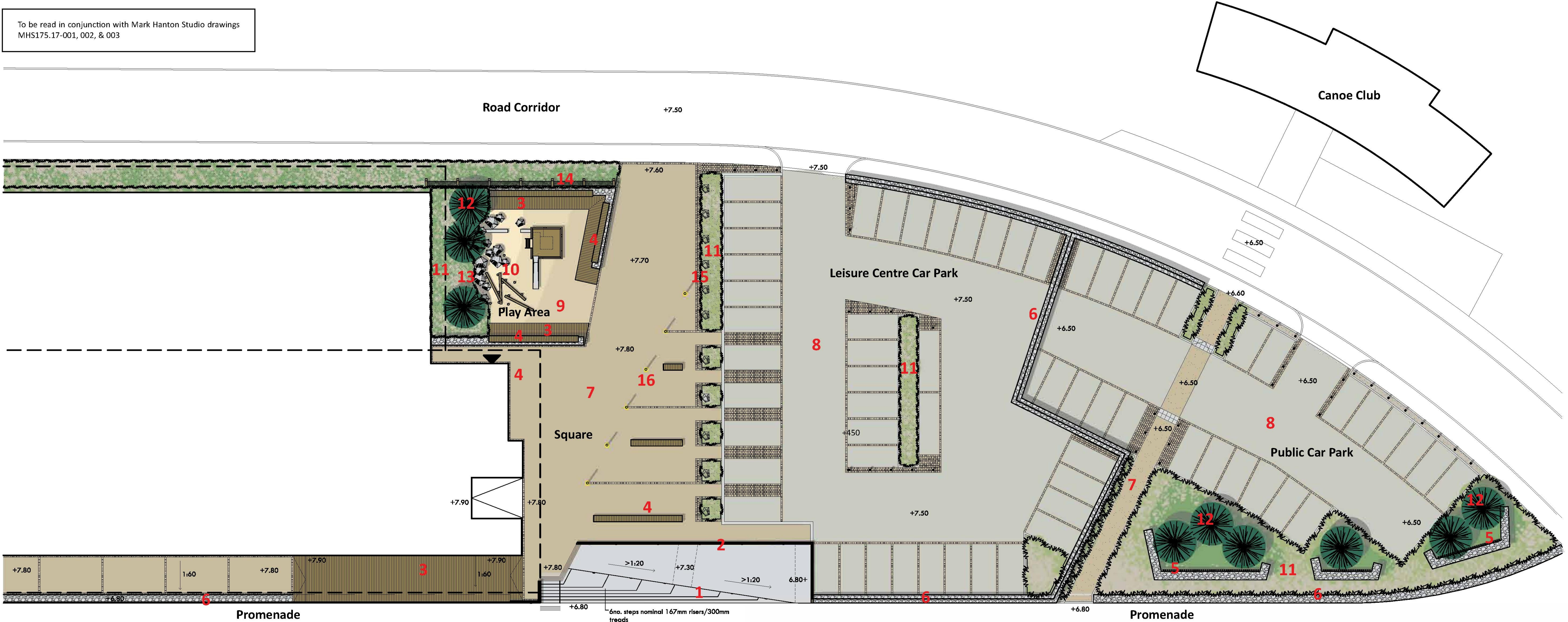

Key

- 1 Concrete entrance steps and flush access (>1:20 grade), with robust stainless steel nosings, and handrails
- 2 Timber post retaining wall with stainless steel guardrail above
- 3 Decked areas
- 4 Timber seating
- 5 Gabion/timber wind breaks (to provide shelter for tree / shrub planting)
- 6 Gabion wall with stainless steel guardrail
- 7 Resin bound gravel surface with cobble trims / margins
- 8 Resin bonded gravel surface with exposed aggregate kerbing and cobble trims
- 9 Sand play surface
- 10 Play items
- 11 Coastal planting (species locations subject to exposure)
- 12 Trees (Pinus pinea or similar suitable for coastal conditions)
- 13 Play boulders
- 14 Screen - timber posts on steel supports with stainless steel tension wires/netting and climbing plants
- 15 Rock bollards
- 16 Light posts

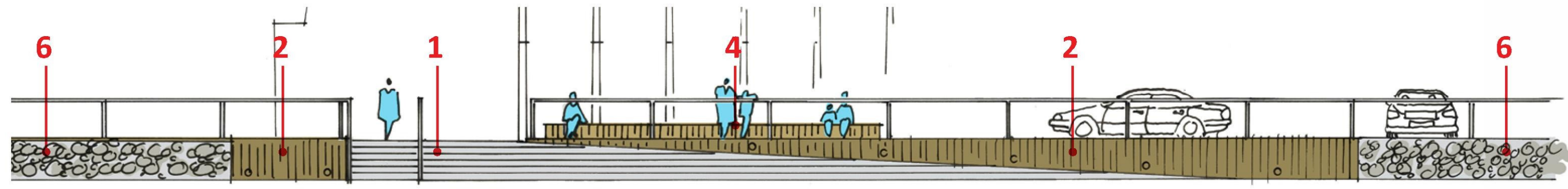

Elevation - Entrance Steps

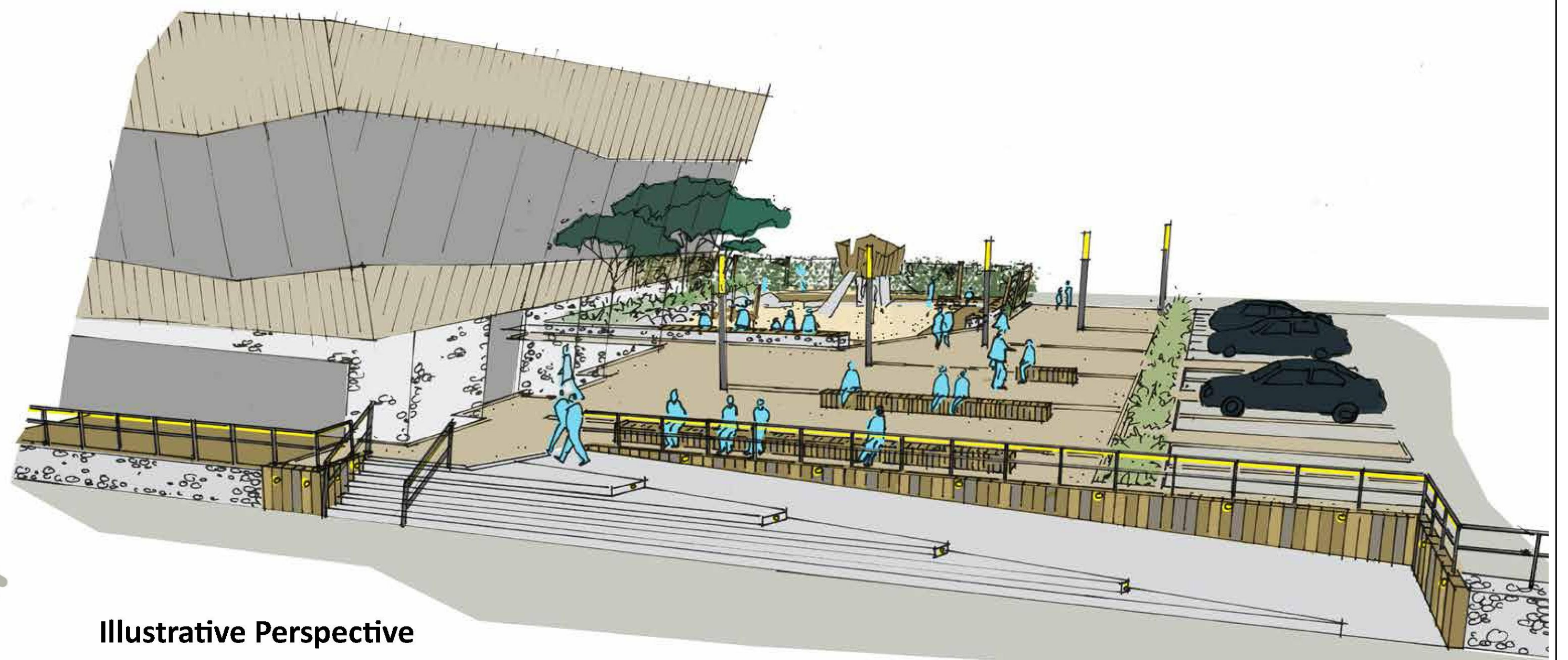

Illustrative Perspective

LANDSCAPE PROPOSALS 1 OF 2

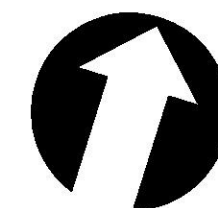
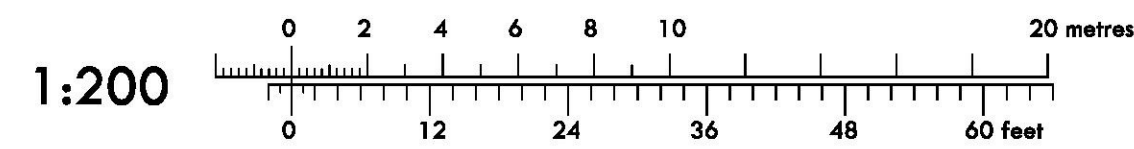

| NO. | DESCRIPTION   | DATE       | BY  | CHECK |
|-----|---|------------|-----|-------|
| A   | First issue   | 12.05.2017 | MAH | MAH   |
| B   | Amended to new road alignment and resulting site layout | 06.06.2017 | MAH | MAH   |
| C   | Changes following splash well moving 1m south           | 09.06.2017 | MAH | MAH   |
| D   | Changes to play equipment and northern screen           | 29.06.2017 | MAH | MAH   |

|          |                      |         |     |
|----------|----------------------|---------|-----|
| PROJECT  | Hythe Leisure Centre |         |     |
| CLIENT   | Shedpway DC          |         |     |
| DRG NO.  | MHS175.17-001        |         |     |
| STATUS   | PLANNING             |         |     |
| SCALE    | 1:200@A1             | REV     | D   |
| DRAWN BY | MAH                  | CHECKED | MAH |
| DATE     | 12.06.2017           |         |     |

**MARK HANTON STUDIO.**

Landscape Architecture / Urban Design  
 Unit 28 Brax Close  
 Bramble Lane  
 Wye  
 Ashford  
 Kent, TN25 5HB  
 Telephone: 01233 612444  
 E-mail: info@markhantonstudio.co.uk  
 Website: www.markhantonstudio.co.uk

DO NOT SCALE this drawing. Figured dimensions only are to be used.  
 © This drawing is the sole copyright of markhantonstudio.  
 Any discrepancies between this drawing and other information should be reported to markhantonstudio for clarification.