

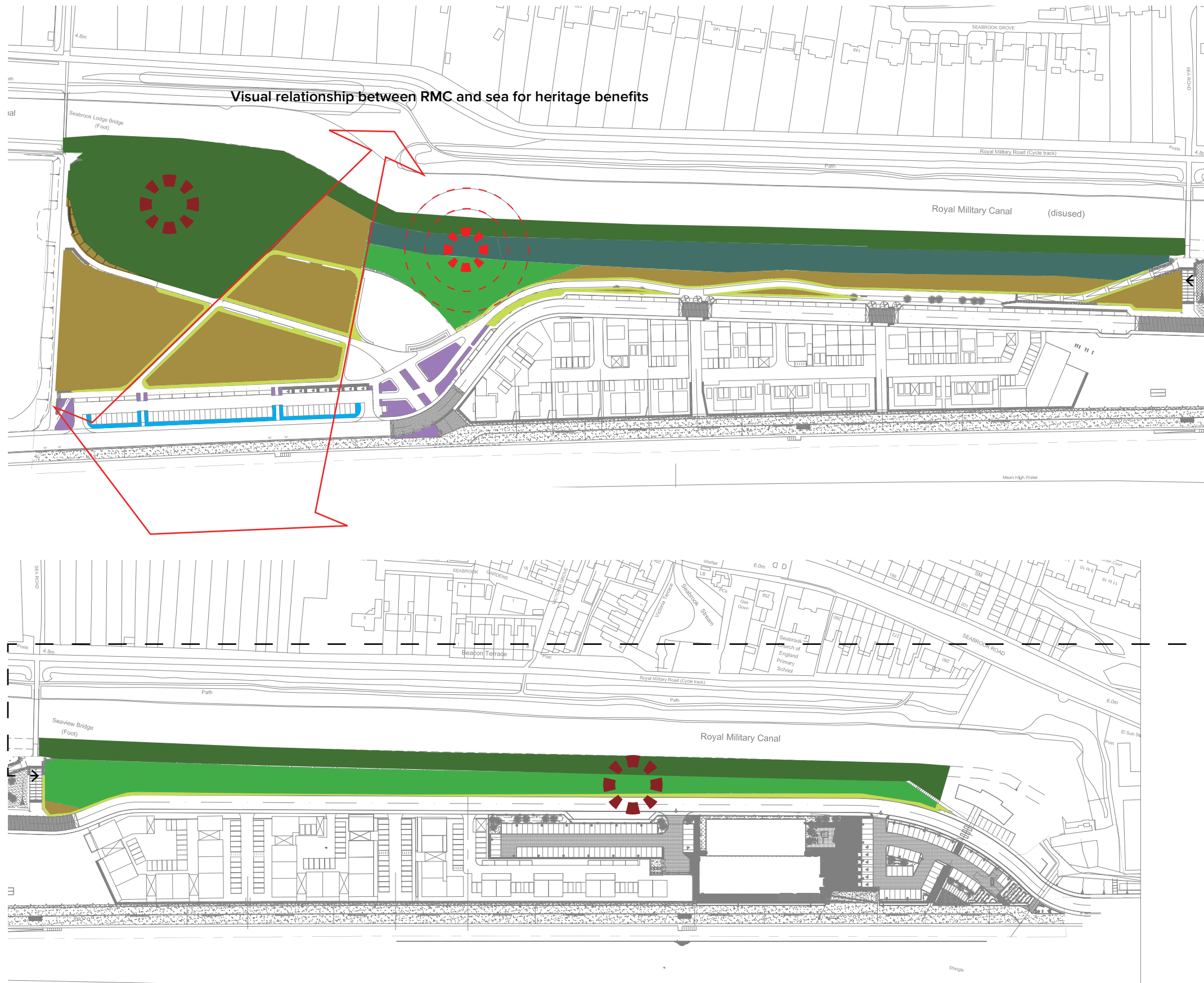







# MHS SK16\_12.05.2021 Proposed Landscape Finishes/Habitats for Western & Linear Parks

Rev B

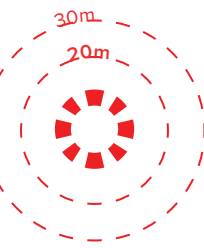

-  Existing vegetation retained as existing
-  Existing vegetation retained and enhanced with new native tree/shrub planting
-  Proposed native tree/shrub planting with 80:20 grass:wildflower groundcover (coastal mix) - 1/2 cuts per year
-  Proposed 80:20 grass:wildflower groundcover (coastal mix) - 1/2 cuts per year
-  Proposed mown grass, as margins to above (circa 21 cuts per year)
-  Proposed shrub/herbaceous planting mix
-  Proposed evergreen hedging
  
-  Existing badger setts
-  Proposed badger sett with distance markers